

HAAS
+
SOHN

Soho

Equipment sheet
Fireplace insert

GB

Introduction

We thank you very much for purchasing our product!

The description of the heating device will inform you in detail about the design, technical specification and operation of the heating device. We recommend you to acquaint yourselves closely with these data. In this way, you will avoid possible faults during the proper assembly and operation.

You will find detailed conditions of installation and operation in General Manual of Operation (included in the scope of the delivery).

Notes in the text

GB



Of utmost importance there are the notes entitled **WARNING**. The notes entitled **WARNING** advise you on **serious danger of damage to the heating device or of an injury**.



The note entitled **Notice** advises you on possible damage to your heating device.



The note entitled **Important** calls your attention to the information important for the operation of your heating device.



The note itself calls your attention to the information important for the operation of your heating device in general.

Contents

1. Dimensioned diagram	1
1.1. Soho right.....	1
1.2. Soho left	2
2. List of spare parts — Soho right	3
2.1. Whole emplacement.....	3
2.2. Detail A1	5
3. List of spare parts — Soho left	6
3.1. Whole emplacement.....	6
3.2. Detail A1	8
4. Easy control	9
5. Change of the external air input	10

1. Dimensioned diagram

1.1. Soho right

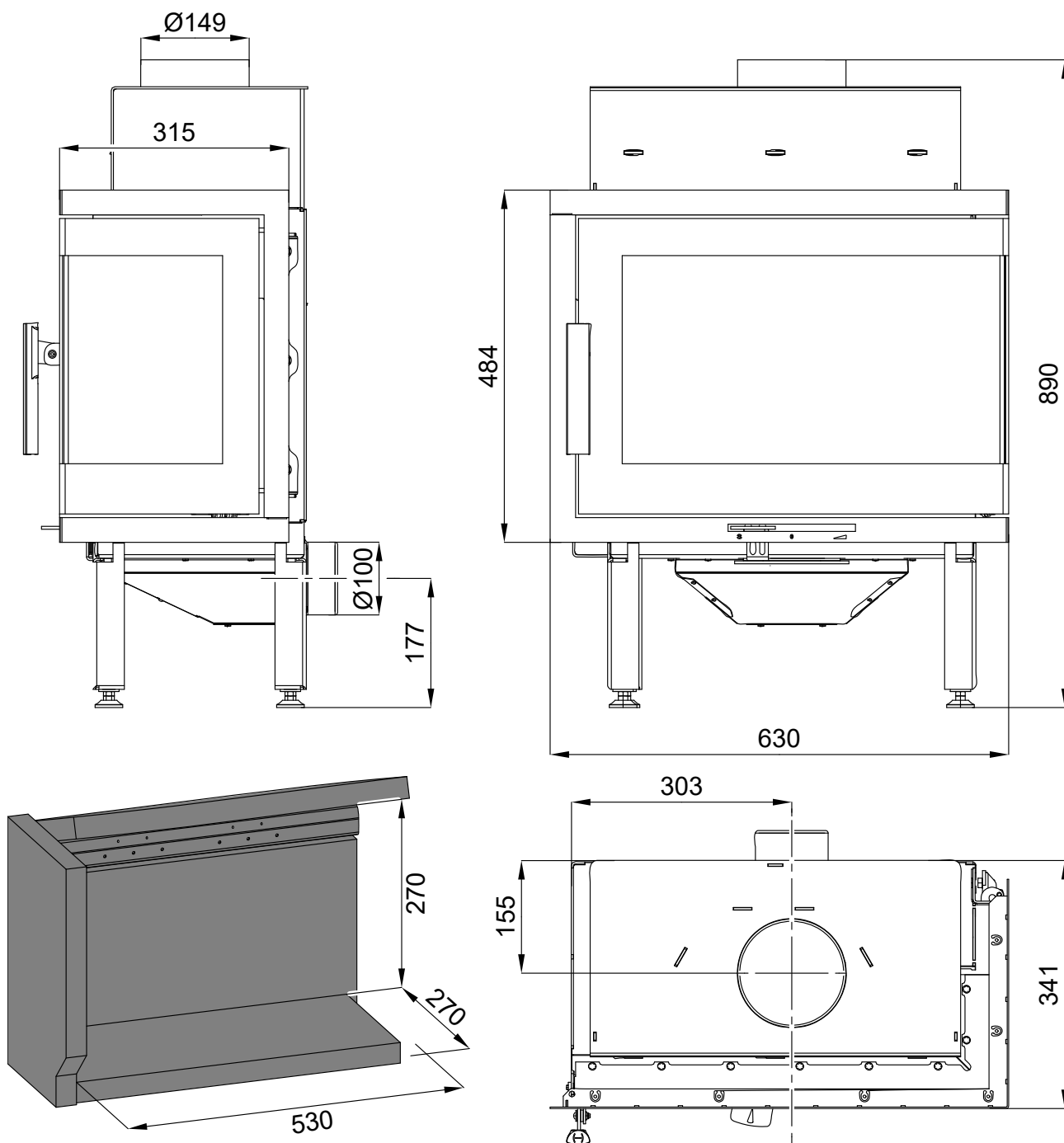

Dimensioned diagram

GB

1.2. Soho left

Dimensioned diagram

GB

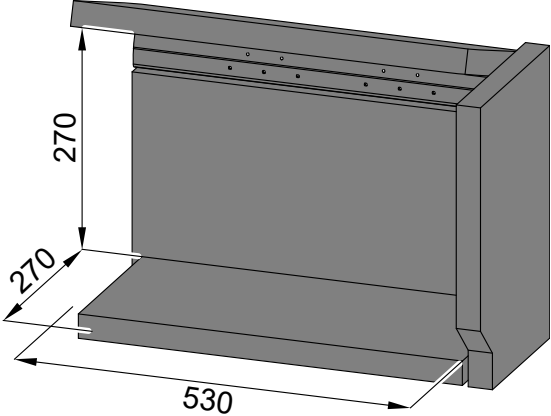
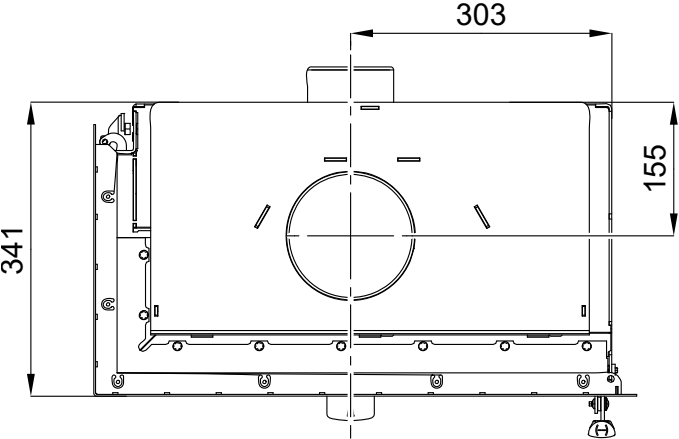
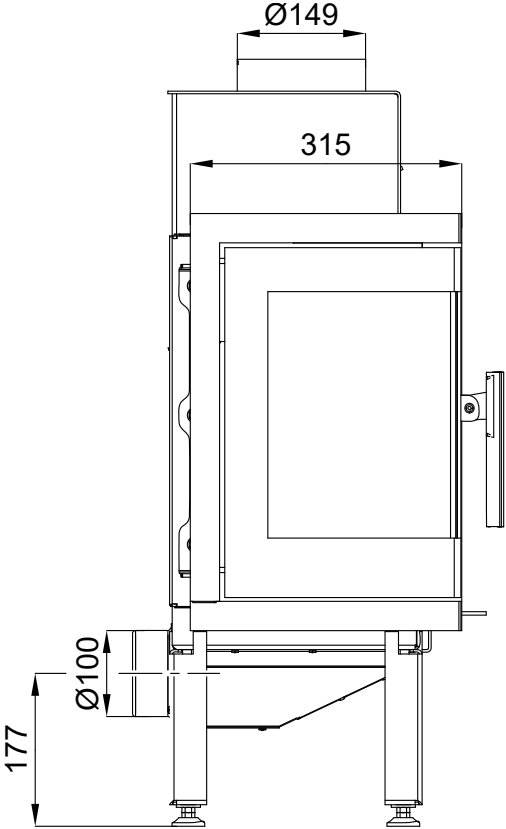
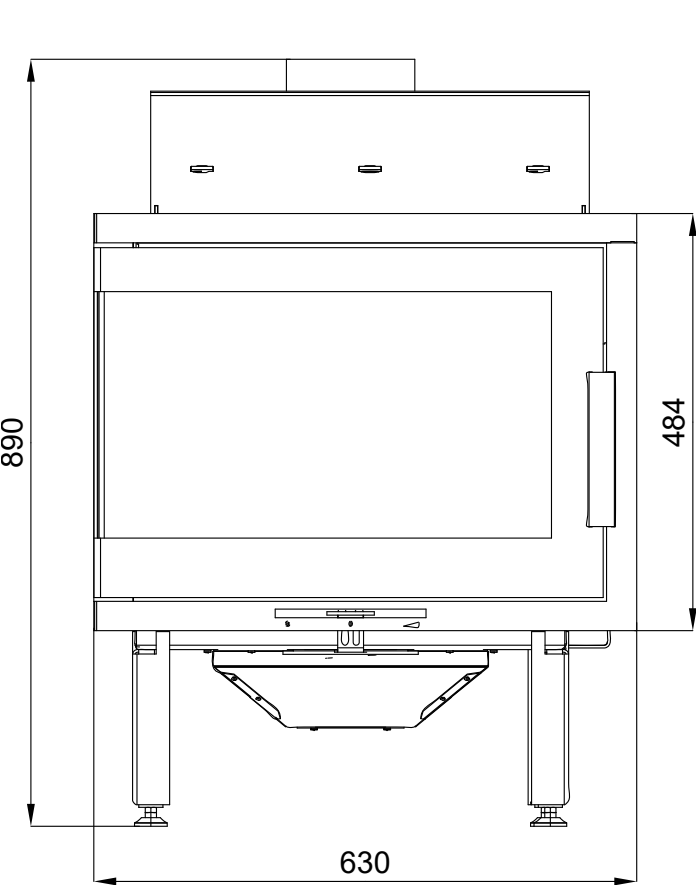

2. List of spare parts — Soho right

2.1. Whole emplacement

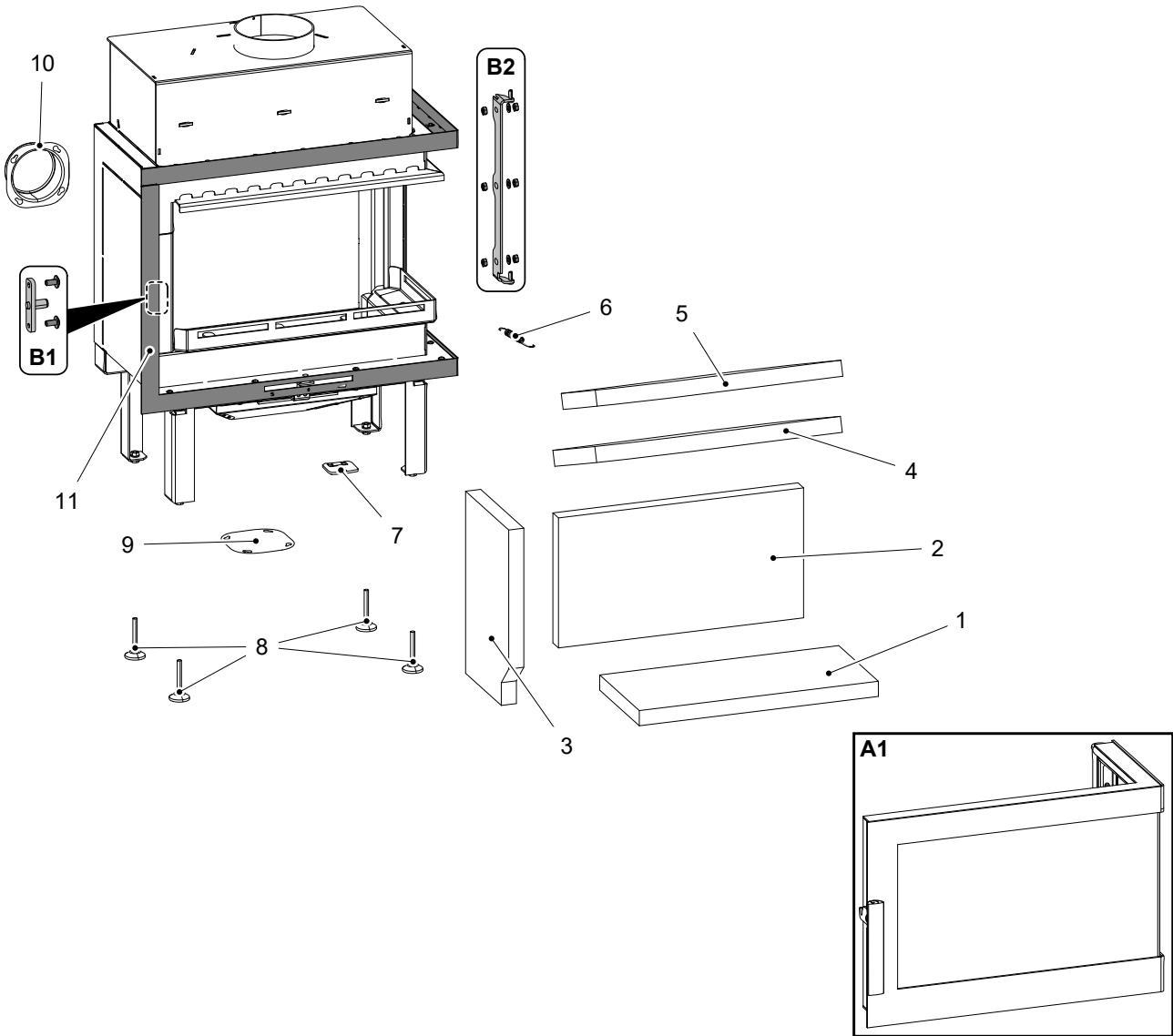

Item	Name	Quantity	Number of goods
Whole emplacement			
A1	Fire-box door (complete)/black	1 piece	0633015005300
B1	Door lock (complete)/black	1 piece	0633015005030
B2	Fire-box door suspension (complete)/black	1 piece	0633015005060
1	Brick 30x213x475	1 piece	0633015005505
2	Brick rear 30x257x487	1 piece	0633015005502

3	Brick side 30x232x360	1 piece	0633015005504
4	Screen lower (30x240x488)	1 piece	0633015005501
5	Screen upper (30x195x488)	1 piece	0633015005503
6	Door spring	1 piece	0428612005002
7	Handrail	1 piece	0633015005009
8	Stand	4 piece	0089000020005
9	Blind flange	1 piece	0633015005022
10	External air input (Ø100)	1 piece	0088500050008
11	Frame/black (optional accessory)	1 piece	0633015001300

2.2. Detail A1

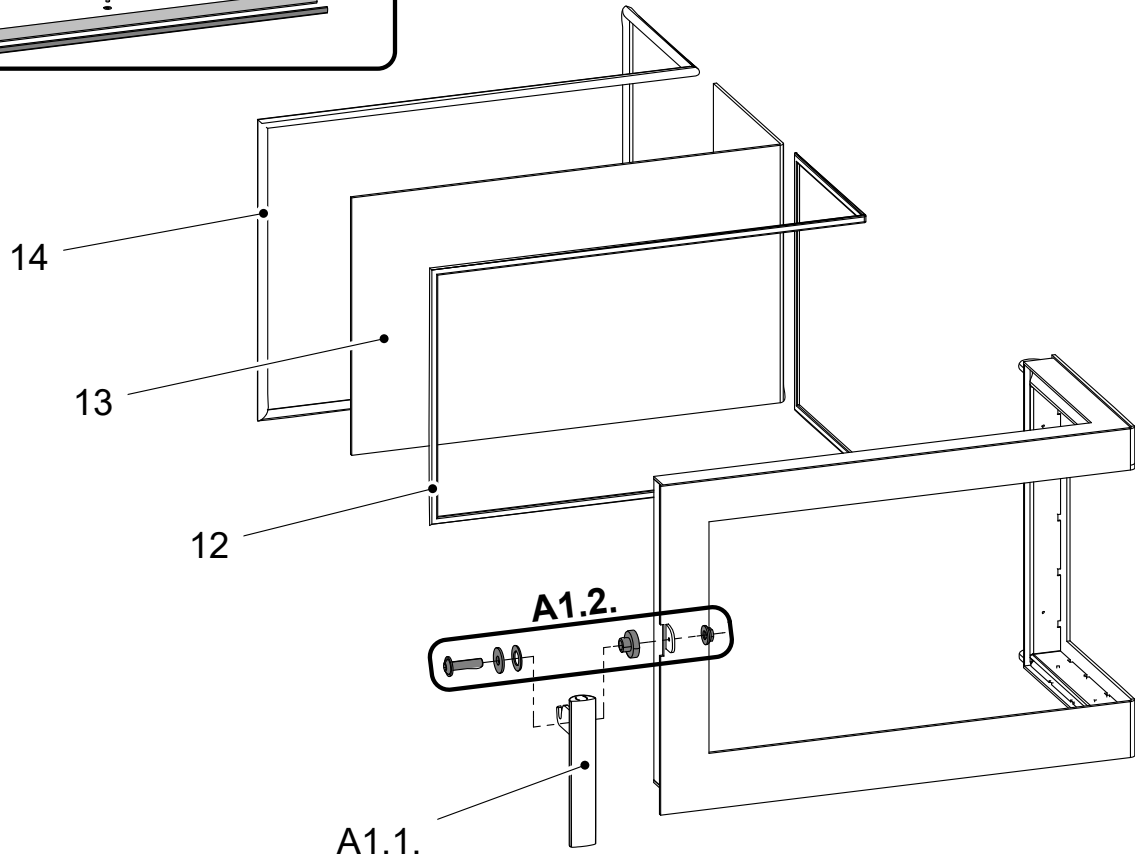
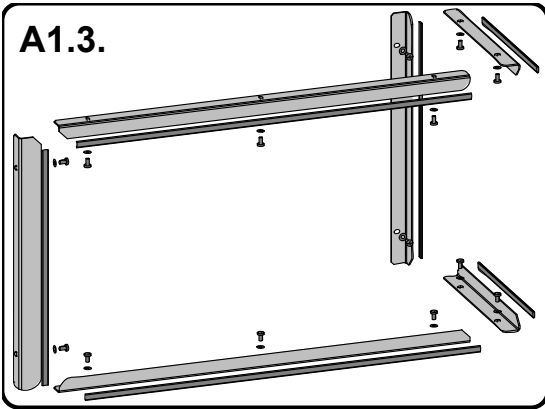

Item	Name	Quantity	Number of goods
Detail A1			
A1.1.	Fire-box door lever lock (complete)	1 piece	0420114015301
A1.2.	Handle connecting material — set	1 piece	0633015005310
A1.3.	Glass holder — set/black	1 piece	0633015005320
12	Glass sealing cord 10x4 mm	2060 mm	0040210040005
13	Refractory glass (4x538/230x318)	1 piece	0633015005330
14	Door sealing cord 12 mm	2300 mm	0041012120005

3. List of spare parts — Soho left

3.1. Whole emplacement

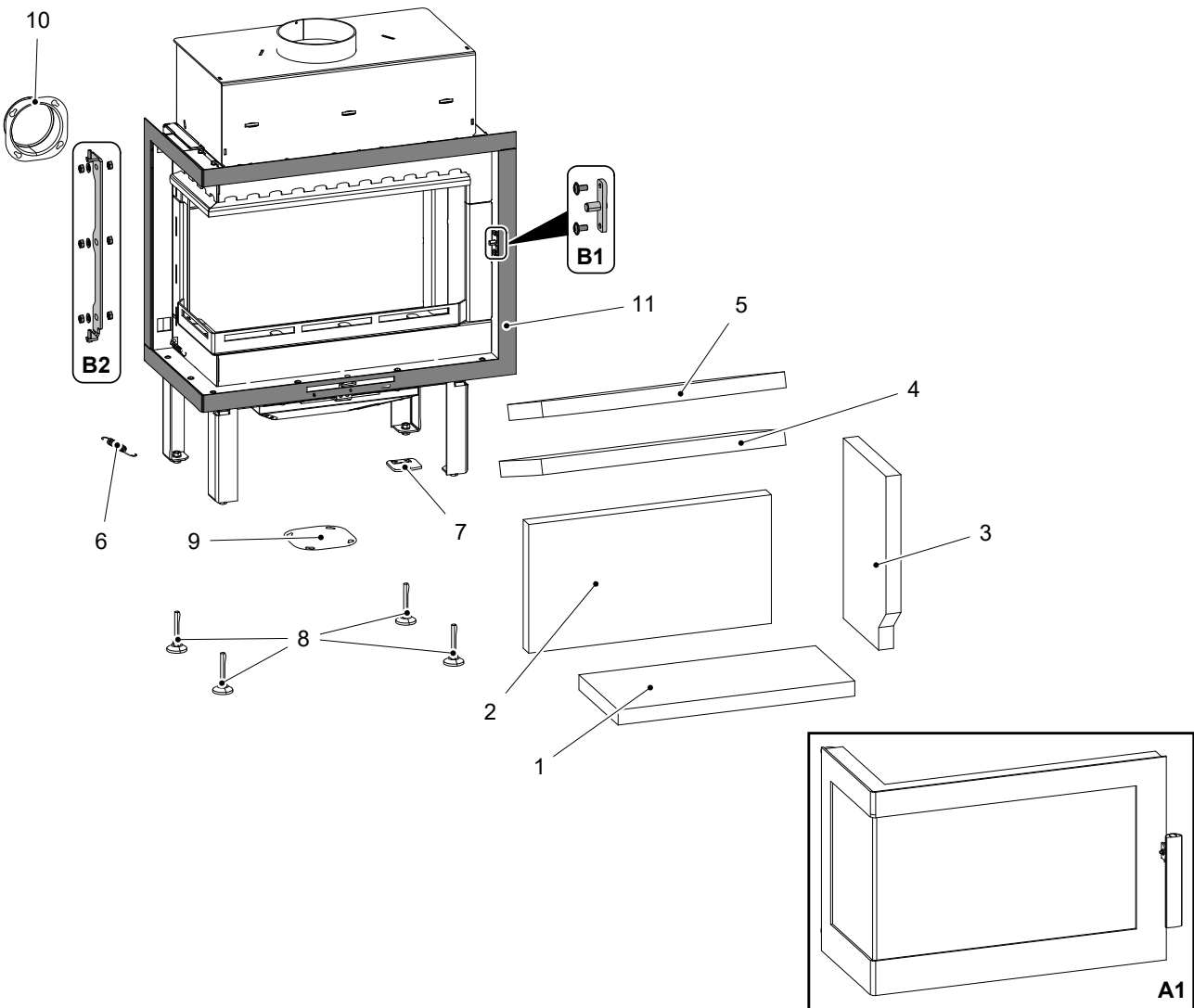

Item	Name	Quantity	Number of goods
Whole emplacement			
A1	Fire-box door (complete)/black	1 piece	0633015105300
B1	Door lock (complete)/black	1 piece	0633015005030
B2	Fire-box door suspension (complete)/black	1 piece	0633015105060
1	Brick 30x213x475	1 piece	0633015005505
2	Brick rear 30x257x487	1 piece	0633015005502
3	Brick side 30x232x360	1 piece	0633015005504
4	Screen lower (30x240x488)	1 piece	0633015005501
5	Screen upper (30x195x488)	1 piece	0633015005503

6	Door spring	1 piece	0428612005002
7	Handrail	1 piece	0633015005009
8	Stand	4 piece	0089000020005
9	Blind flange	1 piece	0633015005022
10	External air input (Ø100)	1 piece	0088500050008
11	Frame/black (optional accessory)	1 piece	0633015101300

3.2. Detail A1

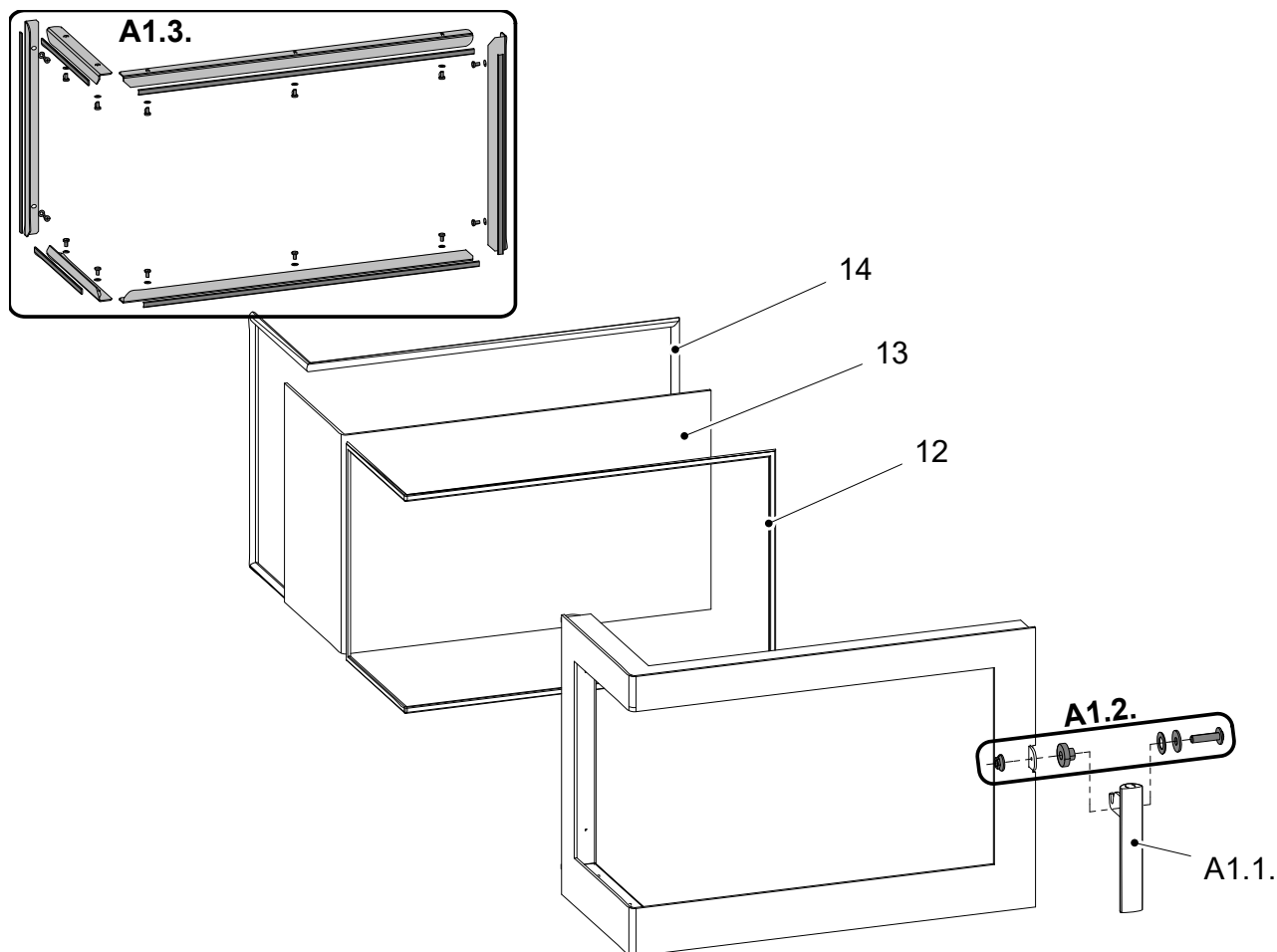

GB

Item	Name	Quantity	Number of goods
Detail A1			
A1.1.	Fire-box door lever lock (complete)	1 piece	0420114015301
A1.2.	Handle connecting material — set	1 piece	0633015005310
A1.3.	Glass holder — set/black	1 piece	0633015005320
12	Glass sealing cord 10x4 mm	2060 mm	0040210040005
13	Refractory glass (4x538/230x318)	1 piece	0633015005330
14	Door sealing cord 12 mm	2300 mm	0041012120005

4. Easy control

Control of all three air inputs - primary, secondary, tertiary - by means of one sole controller.

1. The controller is in the position intended for ignition (fig. A). All three air inputs are open (primary, secondary, tertiary).
2. The controller is in the position intended for burning of the stove after ignition (fig. B).
3. The controller is in the position designed to close air inputs (Fig. C). No input is open (primary, secondary, tertiary). This position is used only when the stove is out of operation, after finishing the heating process.



WARNING

Air inputs may not be closed during the heating operation (Fig. C)! In an extreme case, there can occur an explosion in the stove followed by breaking of glass, blowing up of cinders across the room and breaking out of the fire.

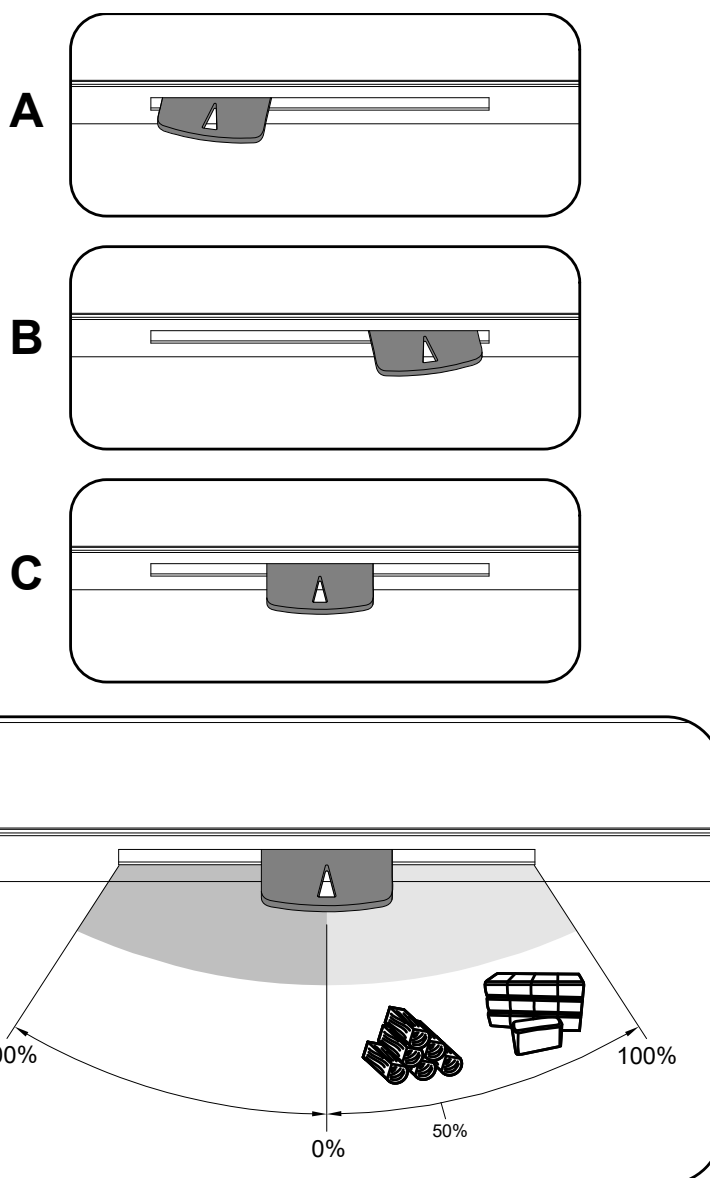

5. Change of the external air input

Change of the external air input

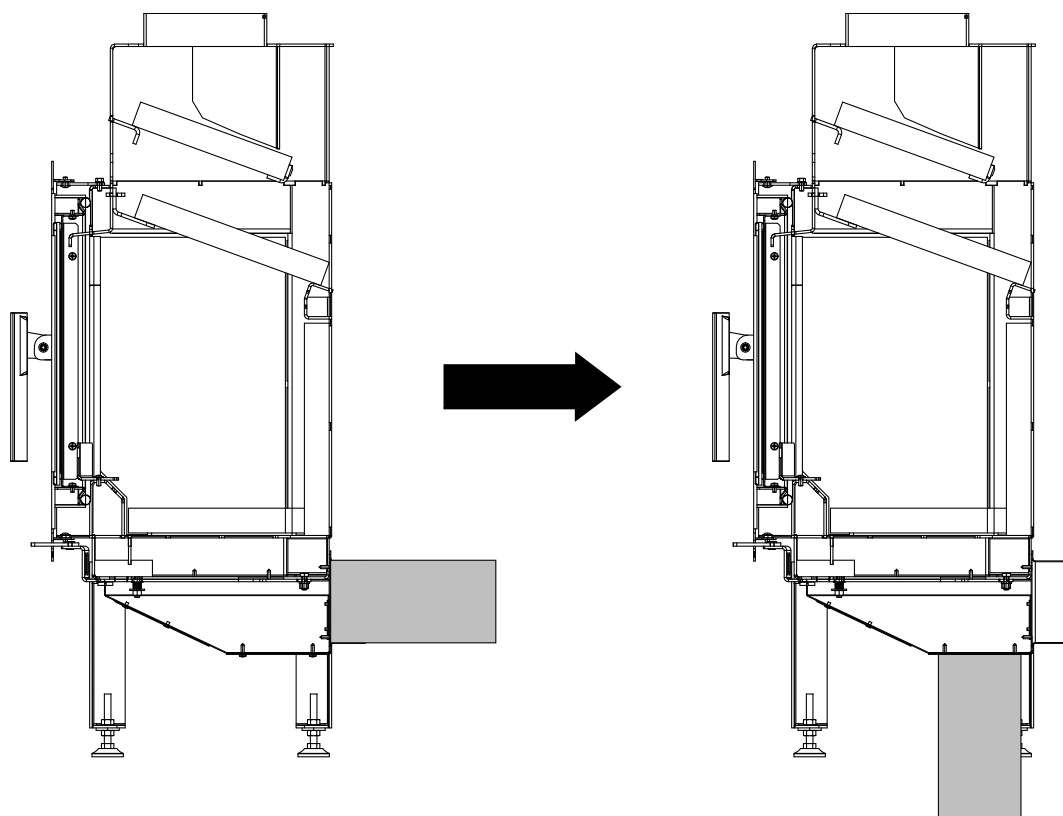

GB

